

welcome to
Whittle Brook Park
Heywood



when it comes to new homes,
we think of everything.

There's so much to consider when you're looking for a new home. From the size to the location, the build quality to the price, making the right choice **really matters**.

At Anwyl Homes, we know what it's like. We should do. After all, we've been building high quality new homes for decades, guiding our customers through the process and helping to unlock happy times ahead.

Whether you're looking for a cosy first property, a spacious family base, or you want to downsize now the kids have moved on, there's an Anwyl home that's right for you.

By combining traditional styling and quality workmanship with the best of today's modern features – not to mention personal touches and friendly smiles every step of the way – your Anwyl experience begins the moment you get in touch. Because with every new home we build, you can be sure we're thinking of you.

Anwyl homes. Everything considered.

*the opportunity to
make your home
YOUR OWN*



got
questions?

call...

01244

445 178



the altham

3 bed semi-detached

A 3 bedroom semi-detached home that welcomes all walks of life. Key features include an *open plan* kitchen/diner and ensuite to bedroom one.

www.anwylhomes.co.uk

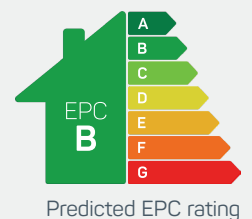



modern
open plan living

ground floor

kitchen/dining 15'4" x 9'8"
living room 12'1" x 20'2"
cloaks 2'11" x 5'3"

kitchen/dining 4.67m x 2.95m
living room 3.67m x 6.15m
cloaks 0.90m x 1.60m



first floor

bedroom 1 8'6" x 14'10"
en-suite 8'7" x 3'4"
bedroom 2 8'6" x 11'7"
bedroom 3 6'6" x 10'7"
bathroom 6'6" x 6'8"

bedroom 1 2.60m x 4.53m
en-suite 2.61m x 1.01m
bedroom 2 2.60m x 3.53m
bedroom 3 1.97m x 3.22m
bathroom 1.97m x 2.02m

the altham
3 bed semi-detached

ANWYL
thoughtful homes

**NEW
HOMES
QUALITY
CODE**

**NEW HOMES
OMBUDSMAN
SERVICE**

www.anwylhomes.co.uk

Anwyl Homes is a Registered Developer with the NHQB. This is a computer-generated image of the altham, elevation treatment may vary. Room sizes are approximate, dimensions are taken from the longest room point (please consult homes advisor for measurement points). Plots may be handed and any garages may be single or double. Kitchen and bathroom layouts are indicative. These plans are correct at the time of going to press, but may be subject to change during construction. Please ensure that you check for specific plot details. Kitchen islands are an optional upgrade to this house type. 29/08/23.

everything considered.

ANWYL
thoughtful homes



the barrowford

3 bed semi-detached

A *modern* 3 bedroom home, perfect for growing families. Key features include a full width kitchen diner with a breakfast bar.

www.anwylhomes.co.uk

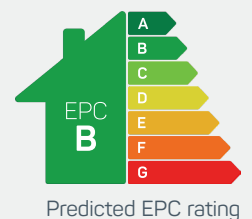



modern
open plan living

ground floor

kitchen/dining 18'11" x 10'7"
living room 11'8" x 15'7"
cloaks 3'1" x 6'11"

kitchen/dining 5.76m x 3.24m
living room 3.55m x 4.74m
cloaks 0.95m x 2.11m

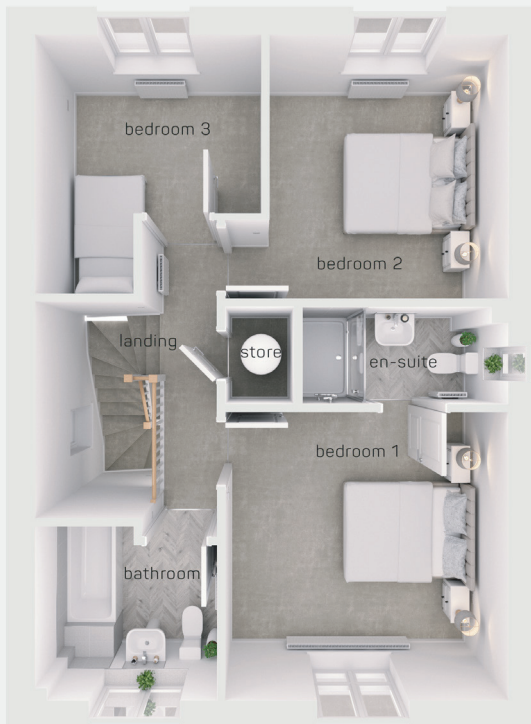

first floor

bedroom 1 11'4" x 11'6"
en-suite 8'3" x 3'11"
bedroom 2 9'7" x 10'7"
bedroom 3 9'1" x 10'4"
bathroom 7'3" x 6'11"

bedroom 1 3.45m x 3.52m
en-suite 2.51m x 1.20m
bedroom 2 2.91m x 3.22m
bedroom 3 2.76m x 3.15m
bathroom 2.21m x 2.11m

the barrowford
3 bed semi-detached

ANWYL
thoughtful homes

**NEW
HOMES
QUALITY
CODE**

**NEW HOMES
OMBUDSMAN
SERVICE**

www.anwylhomes.co.uk

Anwyl Homes is a Registered Developer with the NHQB. This is a computer-generated image of the barrowford, elevation treatment may vary. Room sizes are approximate, dimensions are taken from the longest room point (please consult homes advisor for measurement points). Plots may be handed and any garages may be single or double. Kitchen and bathroom layouts are indicative. These plans are correct at the time of going to press, but may be subject to change during construction. Please ensure that you check for specific plot details. Kitchen islands are an optional upgrade to this house type. 29/08/23.

everything considered.

ANWYL
thoughtful homes



the crawford

3 bed detached with garage

This three-bedroom detached with an integral garage is the *perfect* place to park your family or downsize when they've left home. Key features include ensuite and dressing room to bedroom one.

www.anwylhomes.co.uk

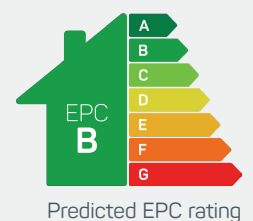



modern
open plan living

ground floor

kitchen/dining 21'1" x 9'5"
living room 10'8" x 16'1"
cloaks 6'5" x 3'6"

kitchen/dining 6.44m x 2.87m
living room 3.26m x 4.91m
cloaks 1.96m x 1.05m



first floor

bedroom 1 12'6" x 10'11"
dressing area 8'3" x 8'8"
en-suite 8'3" x 3'11"
bedroom 2 11'10" x 11'5"
bedroom 3 9'0" x 9'5"
bathroom 8'4" x 6'8"

bedroom 1 3.82m x 3.34m
dressing area 2.52m x 2.64m
en-suite 2.52m x 1.20m
bedroom 2 3.60m x 3.47m
bedroom 3 2.74m x 2.87m
bathroom 2.53m x 2.02m

the crawford
3 bed detached with garage

ANWYL
thoughtful homes

**NEW
HOMES
QUALITY
CODE**

**NEW HOMES
OMBUDSMAN
SERVICE**

www.anwylhomes.co.uk

Anwyl Homes is a Registered Developer with the NHQB. This is a computer-generated image of the crawford, elevation treatment may vary. Room sizes are approximate, dimensions are taken from the longest room point (please consult homes advisor for measurement points). Plots may be handed and any garages may be single or double. Kitchen and bathroom layouts are indicative. These plans are correct at the time of going to press, but may be subject to change during construction. Please ensure that you check for specific plot details. Kitchen islands are an optional upgrade to this house type. 29/08/23.

everything considered.

ANWYL
thoughtful homes



the dalton

3 bed detached

The traditional three bedroom re-imagined, with a beautifully *balanced* layout designed to bring harmony to your home. Key features include a large utility room off the spacious kitchen diner.

www.anwylhomes.co.uk

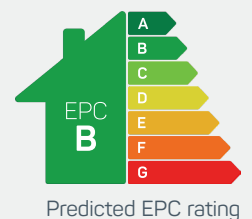



modern
open plan living



ground floor

kitchen/dining	11'6" x 18'6"
living room	10'6" x 18'6"
utility	6'8" x 6'8"
cloaks	3'5" x 5'7"

kitchen/dining	3.50m x 5.65m
living room	3.20m x 5.65m
utility	2.02m x 2.02m
cloaks	1.05m x 1.71m



first floor

bedroom 1	10'8" x 18'6"
en-suite	7'4" x 4'11"
bedroom 2	11'4" x 10'10"
bedroom 3	11'3" x 7'5"
bathroom	6'10" x 7'1"

bedroom 1	3.26m x 5.65m
en-suite	2.24m x 1.49m
bedroom 2	3.45m x 3.30m
bedroom 3	3.43m x 2.26m
bathroom	2.08m x 2.15m

the dalton
3 bed detached

ANWYL
thoughtful homes

**NEW
HOMES
QUALITY
CODE**

**NEW HOMES
OMBUDSMAN
SERVICE**

www.anwylhomes.co.uk

Anwyl Homes is a Registered Developer with the NHQB. This is a computer-generated image of the dalton, elevation treatment may vary. Room sizes are approximate, dimensions are taken from the longest room point (please consult homes advisor for measurement points). Plots may be handed and any garages may be single or double. Kitchen and bathroom layouts are indicative. These plans are correct at the time of going to press, but may be subject to change during construction. Please ensure that you check for specific plot details. Kitchen islands are an optional upgrade to this house type. 29/08/23.

everything considered.

ANWYL
thoughtful homes



the dalton

3 bed semi-detached

The traditional three bedroom semi re-imagined, with a beautifully *balanced* layout designed to bring harmony to your home. Key features include a large utility room off the spacious kitchen diner.

www.anwylhomes.co.uk

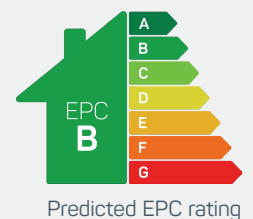



modern
open plan living



ground floor

kitchen/dining	11'6" x 18'6"
living room	10'6" x 18'6"
utility	6'8" x 6'8"
cloaks	3'5" x 5'7"

kitchen/dining	3.50m x 5.65m
living room	3.20m x 5.65m
utility	2.02m x 2.02m
cloaks	1.05m x 1.71m



first floor

bedroom 1	10'8" x 18'6"
en-suite	7'4" x 4'11"
bedroom 2	11'4" x 10'10"
bedroom 3	11'3" x 7'5"
bathroom	6'10" x 7'1"

bedroom 1	3.26m x 5.65m
en-suite	2.24m x 1.49m
bedroom 2	3.45m x 3.30m
bedroom 3	3.43m x 2.26m
bathroom	2.08m x 2.15m

the dalton
3 bed semi-detached

ANWYL
thoughtful homes

**NEW
HOMES
QUALITY
CODE**

**NEW HOMES
OMBUSMAN
SERVICE**

www.anwylhomes.co.uk

Anwyl Homes is a Registered Developer with the NHQB. This is a computer-generated image of the dalton, elevation treatment may vary. Room sizes are approximate, dimensions are taken from the longest room point (please consult homes advisor for measurement points). Plots may be handed and any garages may be single or double. Kitchen and bathroom layouts are indicative. These plans are correct at the time of going to press, but may be subject to change during construction. Please ensure that you check for specific plot details. Kitchen islands are an optional upgrade to this house type. 29/08/23.

everything considered.



the edgworth

3 bed semi-detached

A three bedroom home where you can expect the unexpected with executive levels of *luxury*. Key features include a premium suite to the second floor with a large shower room and walk in wardrobe.

www.anwylhomes.co.uk

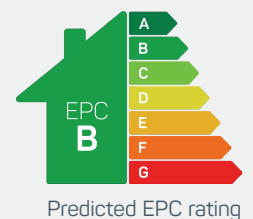

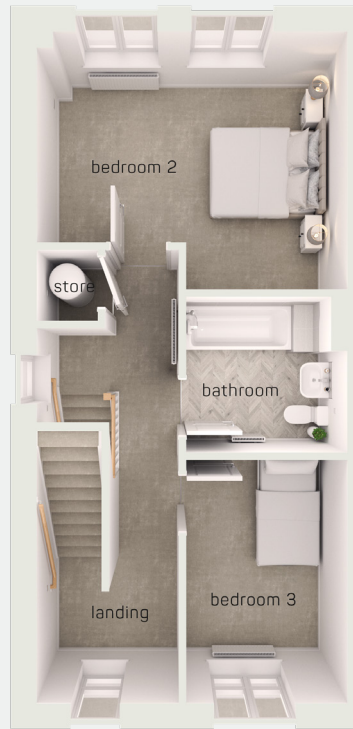

modern
open plan living

ground floor

kitchen/dining 13'11" x 13'9"
living room 10'2" x 16'4"
cloak 3'5" x 6'0"

kitchen/dining 4.25m x 4.18m
living room 3.11m x 4.97m
cloak 1.05m x 1.82m

first floor

bedroom 2 13'11" x 11'8"
bedroom 3 7'3" x 11'0"
bathroom 7'3" x 7'1"

bedroom 2 4.25m x 3.56m
bedroom 3 2.21m x 3.35m
bathroom 2.21m x 2.15m

second floor

bedroom 1 13'11" x 16'8"
en-suite 6'8" x 9'4"

bedroom 1 4.25m x 5.08m
en-suite 2.02m x 2.84m

the edgworth
3 bed semi-detached

ANWYL
thoughtful homes

NEW HOMES QUALITY CODE

NEW HOMES SERVICE OMBUDSMAN

www.anwylhomes.co.uk

Anwyl Homes is a Registered Developer with the NHQB. This is a computer-generated image of the edgworth, elevation treatment may vary. Room sizes are approximate, dimensions are taken from the longest room point (please consult homes advisor for measurement points). Plots may be handed and any garages may be single or double. Kitchen and bathroom layouts are indicative. These plans are correct at the time of going to press, but may be subject to change during construction. Please ensure that you check for specific plot details. 29/08/23.

everything considered.

ANWYL
thoughtful homes



the higham

4 bed detached with garage

The Higham offers high quality at every turn in a *fabulous* four-bedroom detached family home. Key features include a large kitchen kitchen diner with optional kitchen island.

www.anwylhomes.co.uk

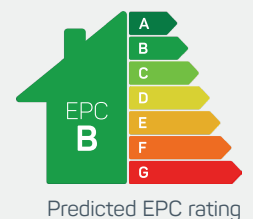



modern
open plan living

ground floor

kitchen/dining	20'9" x 13'0"
living room	12'10" x 16'2"
cloaks	3'2" x 5'8"
kitchen/dining	6.32m x 3.96m
living room	3.90m x 4.92m
cloaks	0.96m x 1.73m



first floor

bedroom 1	11'9" x 11'5"
en-suite	4'5" x 7'8"
bedroom 2	11'9" x 11'3"
bedroom 3	8'8" x 11'0"
bedroom 4	8'8" x 9'0"
bathroom	7'1" x 6'3"
bedroom 1	3.59m x 3.47m
en-suite	1.35m x 2.33m
bedroom 2	3.59m x 3.44m
bedroom 3	2.64m x 3.36m
bedroom 4	2.64m x 2.75m
bathroom	2.15m x 1.90m



the higham
4 bed detached with garage

ANWYL
thoughtful homes

NEW HOMES QUALITY CODE

NEW HOMES OMBUDSMAN SERVICE

www.anwylhomes.co.uk

Anwyl Homes is a Registered Developer with the NHQB. This is a computer-generated image of the higham, elevation treatment may vary. Room sizes are approximate, dimensions are taken from the longest room point (please consult homes advisor for measurement points). Plots may be handed and any garages may be single or double. Kitchen and bathroom layouts are indicative. These plans are correct at the time of going to press, but may be subject to change during construction. Please ensure that you check for specific plot details. Kitchen islands are an optional upgrade to this house type. 29/08/23.

everything considered.

ANWYL
thoughtful homes



the higham DA

4 bed detached with garage

The Higham offers high quality at every turn in a *fabulous* four-bedroom detached family home. Key features include a large kitchen kitchen diner with optional kitchen island.

www.anwylhomes.co.uk

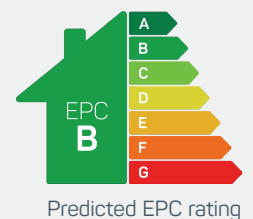



modern
open plan living

ground floor

kitchen/dining	20'9" x 13'0"
living room	12'10" x 16'2"
cloak	3'2" x 5'8"
kitchen/dining	6.32m x 3.96m
living room	3.90m x 4.92m
cloak	0.96m x 1.73m



first floor

bedroom 1	11'9" x 11'5"
en-suite	4'5" x 7'8"
bedroom 2	11'9" x 11'3"
bedroom 3	8'8" x 11'0"
bedroom 4	8'8" x 9'0"
bathroom	7'1" x 6'3"
bedroom 1	3.59m x 3.47m
en-suite	1.35m x 2.33m
bedroom 2	3.59m x 3.44m
bedroom 3	2.64m x 3.36m
bedroom 4	2.64m x 2.75m
bathroom	2.15m x 1.90m

the higham DA
4 bed detached with garage

ANWYL
thoughtful homes

NEW HOMES QUALITY CODE

NEW HOMES OMBUDSMAN SERVICE

www.anwylhomes.co.uk

Anwyl Homes is a Registered Developer with the NHQB. This is a computer-generated image of the higham, elevation treatment may vary. Room sizes are approximate, dimensions are taken from the longest room point (please consult homes advisor for measurement points). Plots may be handed and any garages may be single or double. Kitchen and bathroom layouts are indicative. These plans are correct at the time of going to press, but may be subject to change during construction. Please ensure that you check for specific plot details. Kitchen islands are an optional upgrade to this house type. 29/08/23.

everything considered.



the kirkham

4 bed semi-detached

Flow is the key to the Kirkham, with four bedrooms over three floors. Key features include the impressive second floor with en-suite bedroom one and a single bedroom, which could be used as a study, a dressing room, or even a nursery.

www.anwylhomes.co.uk

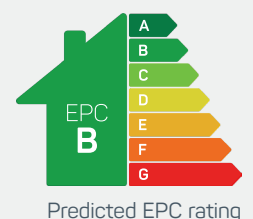



modern
open plan living



ground floor

kitchen 7'3" x 14'3"
living room 15'8" x 17'7"
cloaks 3'2" x 5'6"

kitchen 2.21m x 4.35m
living room 4.78m x 5.34m
cloaks 0.96m x 1.67m

first floor

bedroom 2 15'8" x 9'10"
bedroom 3 15'8" x 9'4"
bathroom 8'8" x 8'0"

bedroom 2 4.78m x 2.99m
bedroom 3 4.78m x 2.84m
bathroom 2.63m x 2.45m



second floor

bedroom 1 15'8" x 14'1"
en-suite 8'3" x 3'11"
bedroom 4 15'8" x 7'6"

bedroom 1 4.78m x 4.28m
en-suite 2.53m x 1.20m
bedroom 4 4.78m x 2.29m

the kirkham
4 bed semi-detached

www.anwyllhomes.co.uk

ANWYL
thoughtful homes

**NEW
HOMES
QUALITY
CODE**

**NEW HOMES
OMBUDSMAN
SERVICE**

Anwyll Homes is a Registered Developer with the NHQB. This is a computer-generated image of the kirkham, elevation treatment may vary. Room sizes are approximate, dimensions are taken from the longest room point (please consult homes advisor for measurement points). Plots may be handed and any garages may be single or double. Kitchen and bathroom layouts are indicative. These plans are correct at the time of going to press, but may be subject to change during construction. Please ensure that you check for specific plot details. 29/08/23.

everything considered.



the lathom

4 bed detached with garage

Four bedrooms and an *integral* garage give the Lathom everything you need and more. Key features include a large kitchen diner with French doors to the rear garden.

www.anwylhomes.co.uk

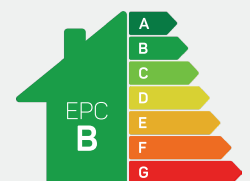

Predicted EPC rating



modern
open plan living

ground floor

kitchen/dining	20'4" x 12'7"
living room	12'1" x 16'2"
utility	6'0" x 6'4"
cloaks	6'0" x 3'5"

kitchen/dining	6.20m x 3.85m
living room	3.67m x 4.91m
utility	1.82m x 1.94m
cloaks	1.82m x 1.05m



first floor

bedroom 1	13'2" x 15'2"
en-suite	8'4" x 3'11"
bedroom 2	10'1" x 13'0"
bedroom 3	13'2" x 8'0"
bedroom 4	11'0" x 9'6"
bathroom	7'2" x 6'2"

bedroom 1	4.01m x 4.61m
en-suite	2.54m x 1.20m
bedroom 2	3.06m x 3.96m
bedroom 3	4.01m x 2.43m
bedroom 4	3.34m x 2.89m
bathroom	2.18m x 1.89m

the lathom
4 bed detached with garage

ANWYL
thoughtful homes

**NEW
HOMES
QUALITY
CODE**

**NEW HOMES
OMBUDSMAN
SERVICE**

www.anwylhomes.co.uk

Anwyl Homes is a Registered Developer with the NHQB. This is a computer-generated image of the lathom, elevation treatment may vary. Room sizes are approximate, dimensions are taken from the longest room point (please consult homes advisor for measurement points). Plots may be handed and any garages may be single or double. Kitchen and bathroom layouts are indicative. These plans are correct at the time of going to press, but may be subject to change during construction. Please ensure that you check for specific plot details. Kitchen islands are an optional upgrade to this house type. 29/08/23.

everything considered.

ANWYL
thoughtful homes



the newburgh

4 bed detached with garage

From the strong, traditional, double-fronted exterior, to the substantial spaces within, the four double bedroom Newburgh is a *classic* of contemporary design. Uncomplicated in its layout, yet uncompromising in its quality, it makes the most of the space to create a generous home of the highest standard.

www.anwylhomes.co.uk

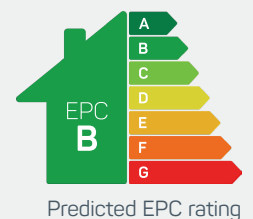



modern
open plan living



ground floor

kitchen/dining	12'8" x 22'3"
utility	6'5" x 7'0"
living room	12'2" x 22'3"
cloaks	3'4" x 5'8"

kitchen/dining	3.86m x 6.77m
utility	1.95m x 2.12m
living room	3.70m x 6.77m
cloaks	1.03m x 1.72m



first floor

bedroom 1	12'2" x 11'6"
en-suite	8'0" x 4'4"
bedroom 2	12'10" x 9'11"
bedroom 3	12'2" x 10'5"
bedroom 4	11'4" x 12'0"
bathroom	8'6" x 6'3"

bedroom 1	3.71m x 3.51m
en-suite	2.44m x 1.31m
bedroom 2	3.91m x 3.01m
bedroom 3	3.71m x 3.17m
bedroom 4	3.45m x 3.67m
bathroom	2.59m x 1.89m

the newburgh
4 bed detached with garage

ANWYL
thoughtful homes

**NEW
HOMES
QUALITY
CODE**

**NEW HOMES
OMBUSMAN
SERVICE**

www.anwylhomes.co.uk

Anwyl Homes is a Registered Developer with the NHQB. This is a computer-generated image of the newburgh, elevation treatment may vary. Room sizes are approximate, dimensions are taken from the longest room point (please consult homes advisor for measurement points). Plots may be handed and any garages may be single or double. Kitchen and bathroom layouts are indicative. These plans are correct at the time of going to press, but may be subject to change during construction. Please ensure that you check for specific plot details. 29/08/23.

everything considered.

ANWYL
thoughtful homes



the rufford

4 bed detached with garage

A four-bedroom detached home that rises above the rest, the Rufford is a revelation. From the extensive *boutique* suite at the top of the home, to the cosy corner of the family room on the ground floor, this is a home that impresses on every level.

www.anwylhomes.co.uk

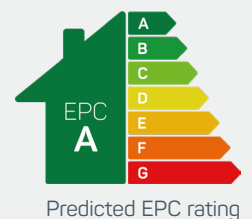



modern
open plan living



ground floor

kitchen/family/ dining	19'3" x 16'2"
living room	11'8" x 15'7"
cloaks	3'0" x 6'3"

kitchen	5.87m x 4.92m
living room	3.56m x 4.74m
cloaks	0.91m x 1.91m

first floor

bedroom 2	11'9" x 10'1"
en-suite 2	8'7" x 3'11"
bedroom 3	11'9" x 12'1"
bedroom 4	10'0" x 8'2"
bathroom	7'2" x 6'3"

bedroom 2	3.58m x 3.06m
en-suite 2	2.61m x 1.20m
bedroom 3	3.59m x 3.67m
bedroom 4	3.05m x 2.50m
bathroom	2.19m x 1.91m

second floor

bedroom 1	19'3" x 23'4"
en-suite	6'11" x 8'5"

bedroom 1	5.87m x 7.10m
en-suite	2.11m x 2.57m

the rufford
4 bed detached with garage

ANWYL
thoughtful homes

**NEW
HOMES
QUALITY
CODE**

**NEW HOMES
OMBUDSMAN
SERVICE**

www.anwylhomes.co.uk

Anwyl Homes is a Registered Developer with the NHQB. This is a computer-generated image of the rufford, elevation treatment may vary. Room sizes are approximate, dimensions are taken from the longest room point (please consult homes advisor for measurement points). Plots may be handed and any garages may be single or double. Kitchen and bathroom layouts are indicative. These plans are correct at the time of going to press, but may be subject to change during construction. Please ensure that you check for specific plot details. 29/08/23.

everything considered.

ANWYL
thoughtful homes



the hollingworth

4 bed detached with garage

Four double bedrooms and two living areas give the Hollingworth a *Supreme* sense of space. Key features include a walk out balcony over the integral garage.

www.anwylhomes.co.uk

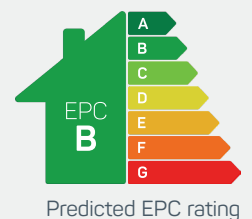



modern
open plan living

ground floor

kitchen/dining	28'11" x 11'3"
living room	10'5" x 16'9"
utility	6'2" x 5'7"
cloaks	6'9" x 3'8"
kitchen/dining	8.80m x 3.43m
living room	3.17m x 5.11m
utility	1.89m x 1.69m
cloaks	2.06m x 1.11m



first floor

bedroom 1	10'5" x 15'2"
en-suite	7'2" x 7'4"
bedroom 2	10'9" x 14'11"
bedroom 3	10'5" x 13'0"
bedroom 4	10'4" x 11'5"
bathroom	7'5" x 9'8"
bedroom 1	3.17m x 4.62m
en-suite	2.18m x 2.24m
bedroom 2	3.27m x 4.55m
bedroom 3	3.17m x 3.97m
bedroom 4	3.16m x 3.48m
bathroom	2.25m x 2.93m

the hollingworth
4 bed detached with garage

ANWYL
thoughtful homes

**NEW
HOMES
QUALITY
CODE**

**NEW HOMES
OMBUDSMAN
SERVICE**

www.anwylhomes.co.uk

Anwyl Homes is a Registered Developer with the NHQB. This is a computer-generated image of the hollingworth, elevation treatment may vary. Room sizes are approximate, dimensions are taken from the longest room point (please consult homes advisor for measurement points). Plots may be handed and any garages may be single or double. Kitchen and bathroom layouts are indicative. These plans are correct at the time of going to press, but may be subject to change during construction. Please ensure that you check for specific plot details. Kitchen islands are an optional upgrade to this house type. 29/08/23.

everything considered.

ANWYL
thoughtful homes



the tatham

4 bed detached with garage

Luxury comes as standard with the four-bedroom Tatham, a home of the highest quality. The Tatham has everything you would expect in an executive four-bedroom home. Key features include a separate downstairs study, two ensuites, and a Juliet balcony to selected plots.

www.anwylhomes.co.uk

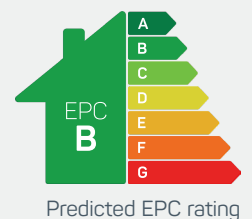



modern
open plan living

ground floor

kitchen/dining/ family	26'4" x 10'9"
utility	7'9" x 5'10"
living room	10'9" x 19'2"
study	8'4" x 9'8"
cloaks	3'1" x 5'10"

kitchen/dining/ family	8.01m x 3.27m
utility	2.35m x 1.77m
living room	3.29m x 5.83m
study	2.54m x 2.95m
cloaks	0.93m x 1.77m



first floor

bedroom 1	13'10" x 16'6"
en-suite 1	6'7" x 7'6"
bedroom 2	10'10" x 9'10"
en-suite 2	7'6" x 3'11"
bedroom 3	8'4" x 13'2"
bedroom 4	7'9" x 9'10"
bathroom	7'1" x 9'10"

bedroom 1	4.22m x 5.03m
en-suite 1	2.00m x 2.30m
bedroom 2	3.30m x 2.98m
en-suite 2	2.27m x 1.20m
bedroom 3	2.54m x 4.02m
bedroom 4	2.37m x 2.98m
bathroom	2.15m x 2.98m

the tatham
4 bed detached with garage

ANWYL
thoughtful homes

**NEW
HOMES
QUALITY
CODE**

**NEW HOMES
OMBUSMAN
SERVICE**

www.anwylhomes.co.uk

Anwyl Homes is a Registered Developer with the NHQB. This is a computer-generated image of the tatham, elevation treatment may vary. Room sizes are approximate, dimensions are taken from the longest room point (please consult homes advisor for measurement points). Plots may be handed and any garages may be single or double. Kitchen and bathroom layouts are indicative. These plans are correct at the time of going to press, but may be subject to change during construction. Please ensure that you check for specific plot details. 29/08/23.

everything considered.

ANWYL
thoughtful homes



the whitworth

5 bed detached with garage

The five-bedroom Whitworth raises the bar, delivering quality without compromise over three floors. Spanning the entire second floor is the *boutique* premier bedroom suite, with a bath and a double shower, plus twin sinks. When it comes to exceptional executive living, The Whitworth is without equal, providing the highest standards on every level.

www.anwylhomes.co.uk

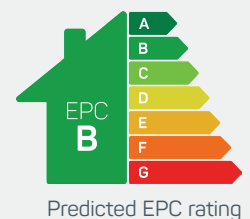



modern
open plan living



ground floor

kitchen/dining/family	28'2" x 10'10"
living room	10'5" x 16'5"
utility	6'0" x 5'8"
cloaks	6'9" x 4'0"

kitchen/dining/family	8.57m x 3.30m
living room	3.17m x 5.01m
utility	1.82m x 1.72m
cloaks	2.06m x 1.22m

first floor

bedroom 2	10'5" x 14'1"
en-suite	7'6" x 5'1"
bedroom 3	10'6" x 14'1"
bedroom 4	10'5" x 13'4"
bedroom 5	10'0" x 10'9"
bathroom	6'10" x 8'8"

bedroom 2	3.17m x 4.29m
en-suite	2.27m x 1.55m
bedroom 3	3.19m x 4.29m
bedroom 4	3.17m x 4.07m
bedroom 5	3.05m x 3.29m
bathroom	2.08m x 2.63m

second floor

bedroom 1	17'4" x 22'9"
en-suite	10'6" x 10'7"

bedroom 1	5.29m x 6.93m
en-suite	3.19m x 3.22m

the whitworth
5 bed detached with garage

ANWYL
thoughtful homes

NEW HOMES QUALITY CODE

NEW HOMES OMBUDSMAN SERVICE

www.anwylhomes.co.uk

Anwyl Homes is a Registered Developer with the NHQB. This is a computer-generated image of the whitworth, elevation treatment may vary. Room sizes are approximate, dimensions are taken from the longest room point (please consult homes advisor for measurement points). Plots may be handed and any garages may be single or double. Kitchen and bathroom layouts are indicative. These plans are correct at the time of going to press, but may be subject to change during construction. Please ensure that you check for specific plot details. 29/08/23.

everything considered.

Whittle Brook Park, Heywood

manchester road



everything considered.

got questions?

call 01706 438 437



email: whittlebrookpark@anwyl.co.uk
Manchester Road, Heywood, OL10 2QD

www.anwylhomes.co.uk

everything considered.