

ANWYL  
*thoughtful homes*



**the delamere**  
4 bed detached house

An *impressive* detached family home. Key features include a large open plan kitchen, dining and family room, separate living room and a master en-suite with dressing room.

[www.anwylhomes.co.uk](http://www.anwylhomes.co.uk)

got  
questions?

call...

**03300  
244 944**

*everything considered.*



**ANWYLL**  
thoughtful homes



**ground floor**

kitchen/ family/dining	29'10" x 13'11"
utility	9'7" x 5'7"
living room	18'1" x 11'8"
cloaks	5'7" x 3'6"

kitchen/ family/dining	9.09m x 4.25m
utility	2.92m x 1.70m
living room	5.51m x 3.55m
cloaks	1.70m x 1.08m

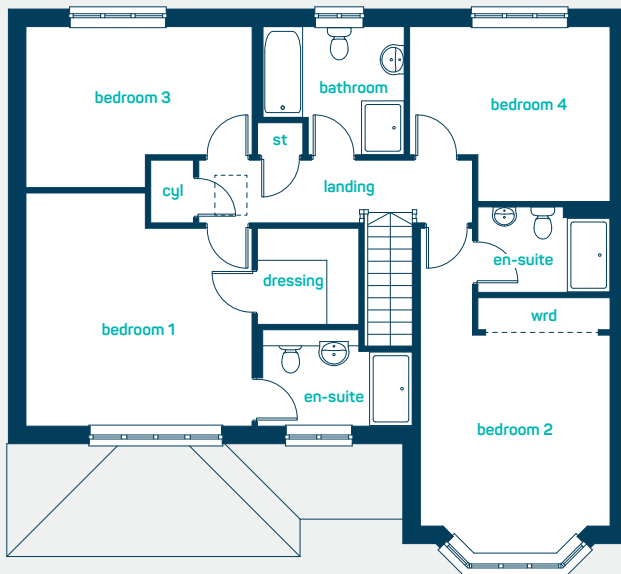

**first floor**

bedroom 1	14'4" x 13'11"
en-suite	9'6" x 6'3"
dressing room	6'1" x 5'7"
bedroom 2*	20'2" x 11'8"
ensuite 2	8'1" x 5'3"
bedroom 3	13'11" x 9'11"
bedroom 4	12'4" x 10'9"
bathroom	8'8" x 7'11"

bedroom 1	4.37m x 4.23m
en-suite	2.90m x 1.91m
dressing room	1.86m x 1.70m
bedroom 2*	6.13m x 3.55m
en-suite 2	2.48m x 1.60m
bedroom 3	4.24m x 3.01m
bedroom 4	3.75m x 3.27m
bathroom	2.65m x 2.40m

get in  
touch...  
**03300  
244 944**

**the delamere**  
4 bed detached house

[www.anwyllhomes.co.uk](http://www.anwyllhomes.co.uk)

This is a computer generated image of the delamere, elevation treatment may vary. \*Room sizes are approximate, dimensions are taken from the longest room point (please consult homes advisor for measurement points). Plots may be handed and any garages may be single or double. Kitchen and bathroom layouts are indicative. These plans are correct at the time of going to press, but may be subject to change during construction. Please ensure that you check for specific plot details.  
20/01/2020

*everything considered.*