

ANWYL
thoughtful homes



the dolwen

4 bed detached with garage

A *beautiful* detached home. Key features include characterful bay windows and a master en-suite bedroom.

www.anwylhomes.co.uk

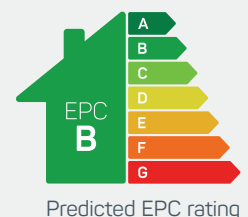

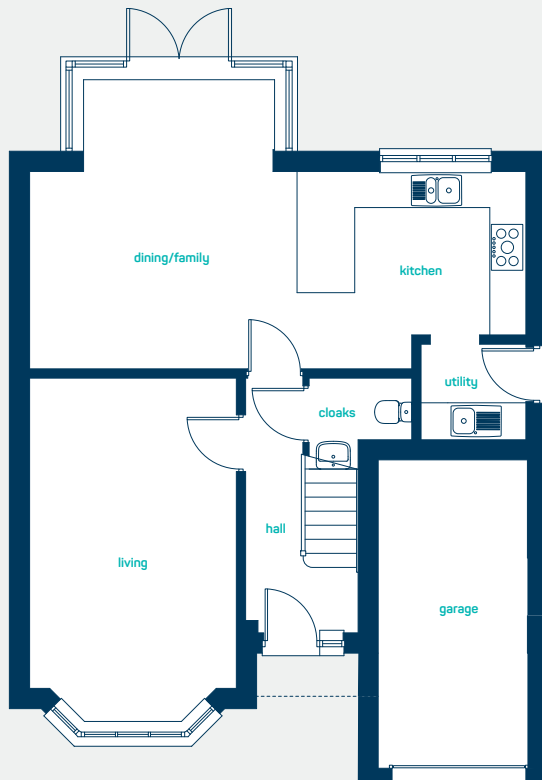

large kitchen with
glazed diner

ground floor

living room	18' 4" x 11' 0"
kitchen/dining	26' 5" x 15' 5"
cloaks	5' 6" x 3' 6"
utility	5' 7" x 5' 4"

living room	5.59m x 3.35m
kitchen/dining	8.05m x 4.69m
cloaks	1.67m x 1.08m
utility	1.70m x 1.63m

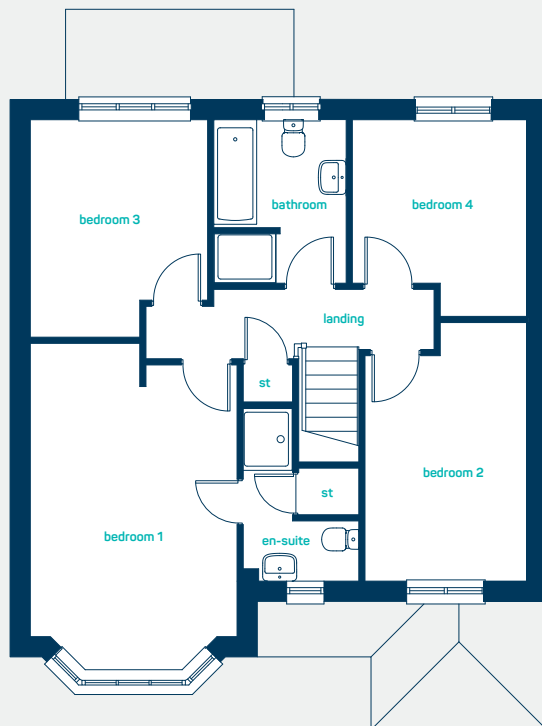

first floor

bedroom 1	17' 5" x 11' 0"
en-suite	9' 2" x 6' 2"
bedroom 2	13' 9" x 8' 6"
bedroom 3	11' 7" x 9' 5"
bedroom 4	10' 5" x 9' 3"
bathroom	8' 9" x 7' 0"

bedroom 1	5.30m x 3.35m
en-suite	2.80m x 1.87m
bedroom 2	4.19m x 2.60m
bedroom 3	3.52m x 2.86m
bedroom 4	3.17m x 2.81m
bathroom	2.68m x 2.15m

the dolwen
4 bed detached with garage

ANWYL
thoughtful homes

**NEW
HOMES
QUALITY
CODE**

**NEW HOMES
OMBUDSMAN
SERVICE**

www.anwylhomes.co.uk

Anwyl Homes is a Registered Developer with the NHQB. This is a computer-generated image of the dolwen, elevation treatment may vary. Room sizes are approximate, dimensions are taken from the longest room point (please consult homes advisor for measurement points). Plots may be handed and any garages may be single or double. Kitchen and bathroom layouts are indicative. These plans are correct at the time of going to press, but may be subject to change during construction. Please ensure that you check for specific plot details. 01/11/22.

everything considered.