

ANWYL
thoughtful homes



the powys

3 bed semi detached

A 3 bedroom semi-detached home. Perfect as a family starter home or for *first-time buyers*.
Key features include an open plan living/dining room with glazed area.

www.anwylhomes.co.uk

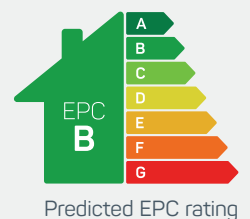

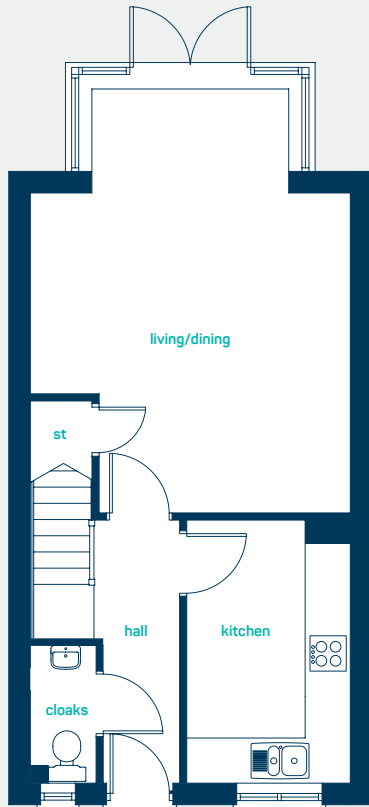

ideal for
first time buyers

ground floor

living/dining 20'2" x 14' 7"
kitchen 12'2" x 7' 6"
cloak 5'10" x 2' 11"

living/dining 6.14m x 4.45m
kitchen 3.70m x 2.28m
cloak 1.77m x 0.90m

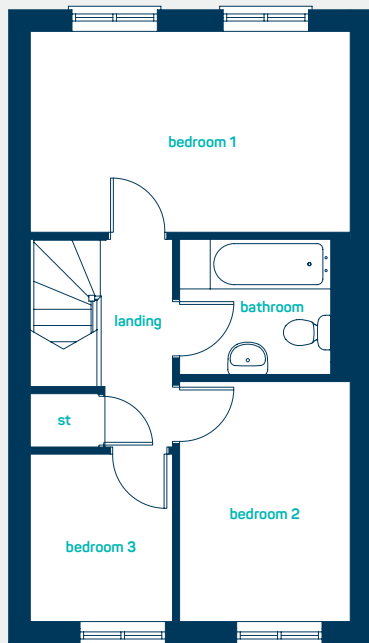

first floor

bedroom 1 14'7" x 9' 2"
bedroom 2 11'0" x 7' 10"
bedroom 3 7'8" x 6' 6"
bathroom 7'0" x 6' 3"

bedroom 1 4.45m x 2.80m
bedroom 2 3.35m x 2.38m
bedroom 3 2.33m x 1.98m
bathroom 2.13m x 1.90m

the powys
3 bed semi detached

ANWYL
thoughtful homes

**NEW
HOMES
QUALITY
CODE**

**NEW HOMES
OMBUDSMAN
SERVICE**

www.anwylhomes.co.uk

Anwyl Homes is a Registered Developer with the NHQB. This is a computer-generated image of the powys, elevation treatment may vary. Room sizes are approximate, dimensions are taken from the longest room point (please consult homes advisor for measurement points). Plots may be handed and any garages may be single or double. Kitchen and bathroom layouts are indicative. These plans are correct at the time of going to press, but may be subject to change during construction. Please ensure that you check for specific plot details. 01/11/22.

everything considered.