

ANWYL  
thoughtful homes



## the kinnerton

3 bed semi-detached

A perfect 3 bedroom semi-detached starter home for first time buyers. Key features include *open plan* kitchen/diner, *spacious lounge* and master bedroom with en-suite.

[www.anwylhomes.co.uk](http://www.anwylhomes.co.uk)

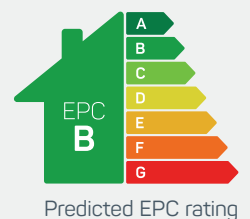

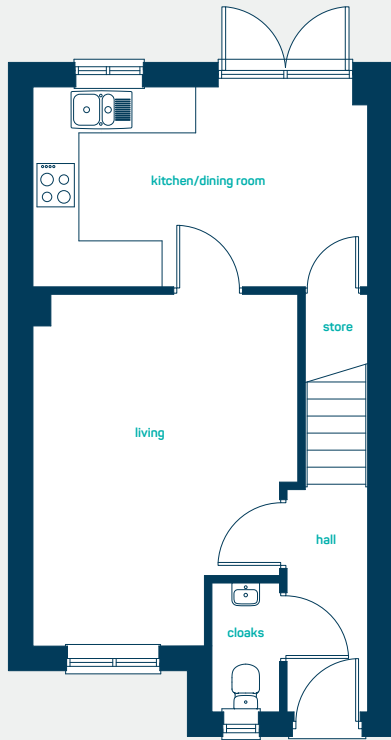

perfect for  
*first time buyers*

### ground floor

kitchen/diner: 14'8" x 8'9"  
living room: 15'5" x 11'8"  
cloaks: 5'8" x 3'0"

kitchen/diner: 4.48m x 2.68m  
living room: 4.71m x 3.54m  
cloaks: 1.73m x 0.91m

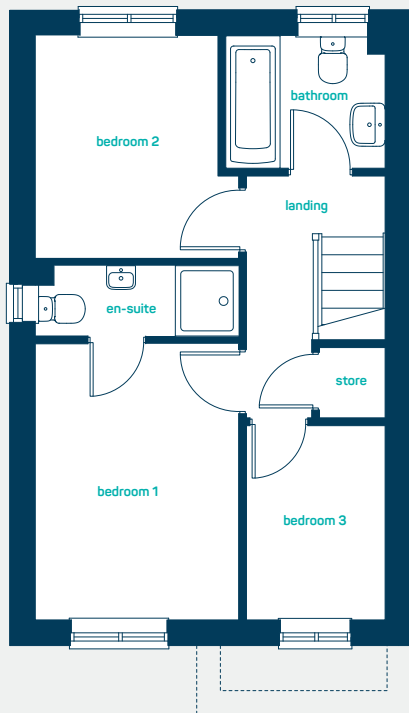

### first floor

bedroom 1: 11'7" x 8'7"  
en-suite: 8'7" x 2'11"  
bedroom 2: 9'4" x 7'8"  
bedroom 3: 8'2" x 5'10"  
bathroom: 6'8" x 5'7"

bedroom 1: 3.54m x 2.60m  
en-suite: 2.60m x 0.90m  
bedroom 2: 2.85m x 2.34m  
bedroom 3: 2.49m x 1.78m  
bathroom: 2.04m x 1.70m

**the kinnerton**  
3 bed semi-detached

**ANWYL**  
*thoughtful homes*

**NEW  
HOMES  
QUALITY  
CODE**

**NEW HOMES  
OMBUDSMAN  
SERVICE**

[www.anwylhomes.co.uk](http://www.anwylhomes.co.uk)

Anwyl Homes is a Registered Developer with the NHQB. This is a computer-generated image of the kinnerton, elevation treatment may vary. Room sizes are approximate, dimensions are taken from the longest room point (please consult homes advisor for measurement points). Plots may be handed and any garages may be single or double. Kitchen and bathroom layouts are indicative. These plans are correct at the time of going to press, but may be subject to change during construction. Please ensure that you check for specific plot details. 01/11/22.

*everything considered.*