

ANWYL
thoughtful homes



the delamere

4 bed detached with double garage

An *impressive* detached 4 bedroom family home. Generously proportioned and superbly designed the delamere offers open plan modern family living space in addition to a separate living room. Classic exteriors, feature high ceilings combined with modern and thoughtfully considered living space, make this the perfect family home.

www.anwylhomes.co.uk

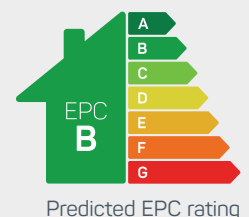



modern
open plan living

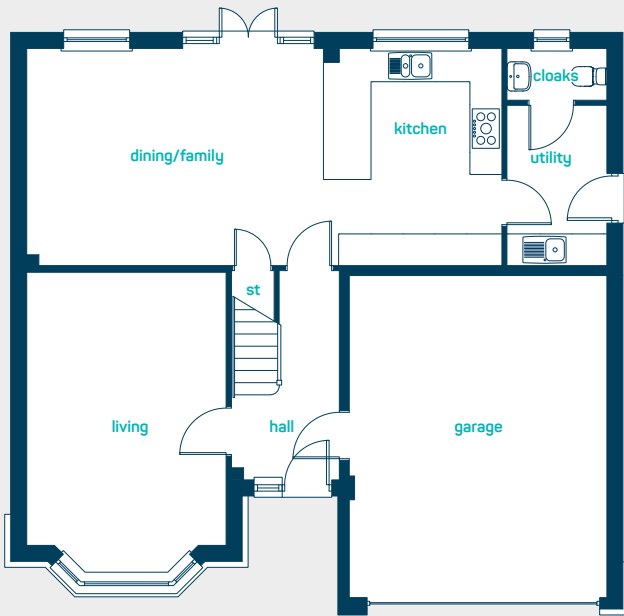

ground floor

kitchen/dining/ family	29'5" x 13'5"
utility	9'11" x 6'1"
living room	18'7" x 12'3"
cloaks	6'1" x 3'2"

kitchen/dining/ family	8.97m x 4.08m
utility	3.03m x 1.87m
living room	5.67m x 3.72m
cloaks	1.87m x 0.95m



first floor

bedroom 1	16'2" x 13'1"
dressing room	7'10" x 6'3"
en-suite 1	9'9" x 5'11"
bedroom 2	20'6" x 12'3"
en-suite 2	8'0" x 5'3"
bedroom 3	13'1" x 10'2"
bedroom 4	12'8" x 10'11"
bathroom	9'1" x 8'1"

bedroom 1	4.92m x 3.99m
dressing room	2.38m x 1.90m
en-suite 1	2.96m x 1.80m
bedroom 2	6.25m x 3.72m
en-suite 2	2.43m x 1.59m
bedroom 3	3.99m x 3.10m
bedroom 4	3.87m x 3.33m
bathroom	2.76m x 2.46m

the delamere
4 bed detached with double garage

ANWYL
thoughtful homes

**NEW
HOMES
QUALITY
CODE**

**NEW HOMES
OMBUDSMAN
SERVICE**

www.anwylhomes.co.uk

Anwyl Homes is a Registered Developer with the NHQB. This is a computer-generated image of the delamere, elevation treatment may vary. Room sizes are approximate, dimensions are taken from the longest room point (please consult homes advisor for measurement points). Plots may be handed and any garages may be single or double. Kitchen and bathroom layouts are indicative. These plans are correct at the time of going to press, but may be subject to change during construction. Please ensure that you check for specific plot details. 01/11/22.

everything considered.