

ANWYL
thoughtful homes



the bretton

3 bed semi-detached

A 3 bedroom semi-detached home. *Perfect* as a family starter home or for first-time buyers. Key features include an open plan kitchen/diner and master bedroom with en-suite.

www.anwylhomes.co.uk



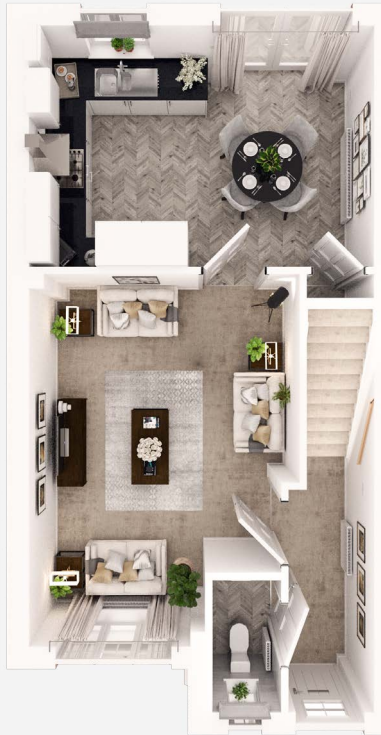

ideal for
growing families

ground floor

living room 16' 8" x 12' 1"
kitchen/dining 15' 5" x 10' 8"
cloaks 5' 11" x 3' 2"

living room 5.10m x 3.70m
kitchen/dining 4.71m x 3.27m
cloaks 1.81m x 0.97m

first floor

bedroom 1 10' 7" x 8' 4"
en-suite 8' 4" x 3' 2"
bedroom 2 11' 0" x 8' 2"
bedroom 3 7' 7" x 6' 9"
bathroom 7' 2" x 6' 9"

bedroom 1 3.25m x 2.55m
en-suite 2.55m x 0.99m
bedroom 2 3.37m x 2.49m
bedroom 3 2.32m x 2.06m
bathroom 2.20m x 2.07m

the bretton
3 bed semi-detached

www.anwylhomes.co.uk

ANWYL
thoughtful homes



Anwyl Homes is a Registered Developer with the NHQB. This is a computer-generated image of the bretton, elevation treatment may vary. Room sizes are approximate, dimensions are taken from the longest room point (please consult homes advisor for measurement points). Plots may be handed and any garages may be single or double. Kitchen and bathroom layouts are indicative. These plans are correct at the time of going to press, but may be subject to change during construction. Please ensure that you check for specific plot details. 24/11/22 (standard version).

everything considered.