

ANWYL
thoughtful homes



the brettton

3 bed semi-detached

A 3 bedroom semi-detached home. *Perfect* as a family starter home or for first-time buyers. Key features include an open plan kitchen/diner and master bedroom with en-suite.

www.anwylhomes.co.uk

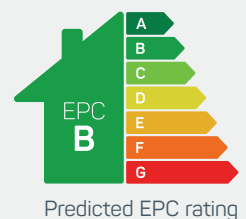

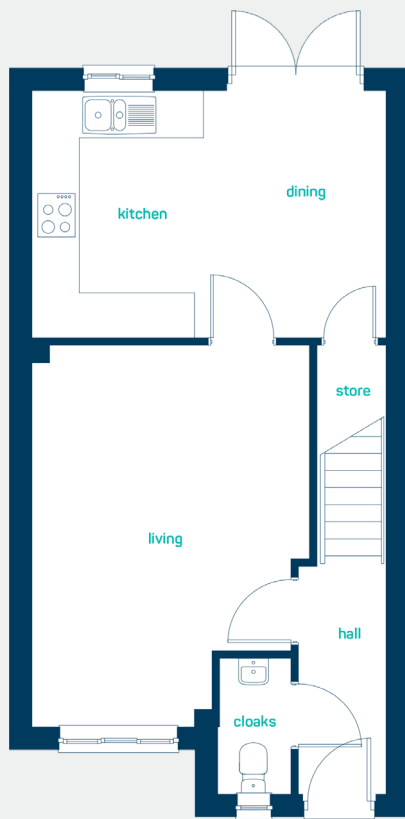

perfect for
first time buyers

ground floor

kitchen/dining 15'6" x 10'9"
living room 12'2" x 16'9"
cloaks 2'11" x 5'7"

kitchen/dining 4.73m x 3.27m
living room 3.71m x 5.10m
cloaks 0.90m x 1.70m

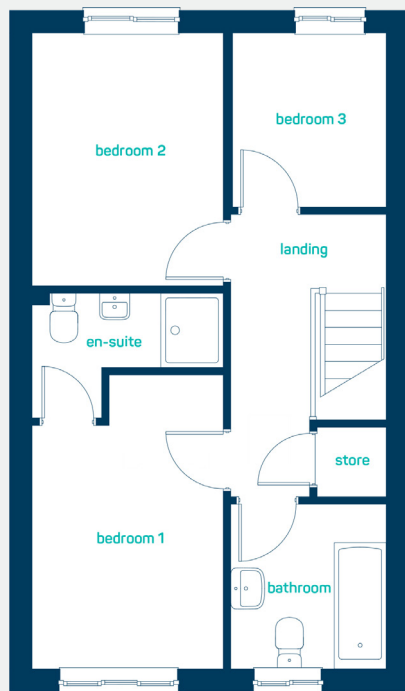

first floor

bedroom 1 8'4" x 12'0"
en-suite 8'4" x 6'2"
bedroom 2 8'4" x 11'3"
bedroom 3 6'11" x 7'8"
bathroom 6'11" x 6'1"

bedroom 1 2.53m x 3.65m
en-suite 2.53m x 1.87m
bedroom 2 2.53m x 3.42m
bedroom 3 2.10m x 2.35m
bathroom 2.10m x 1.86m

the bretton

3 bed semi-detached

www.anwylhomes.co.uk

ANWYL
thoughtful homes

**NEW
HOMES
QUALITY
CODE**

**NEW HOMES
OMBUDSMAN
SERVICE**

Anwyl Homes is a Registered Developer with the NHQB. This is a computer-generated image of the bretton, elevation treatment may vary. Room sizes are approximate, dimensions are taken from the longest room point (please consult homes advisor for measurement points). Plots may be handed and any garages may be single or double. Kitchen and bathroom layouts are indicative. These plans are correct at the time of going to press, but may be subject to change during construction. Please ensure that you check for specific plot details. 03/09/23.

everything considered.