



The Marlow

3 bed mid mews

A wonderful three-bedroom home that's perfect for young families or downsizers who still want a little extra space.



anwylhomes.co.uk

Ground Floor Plan

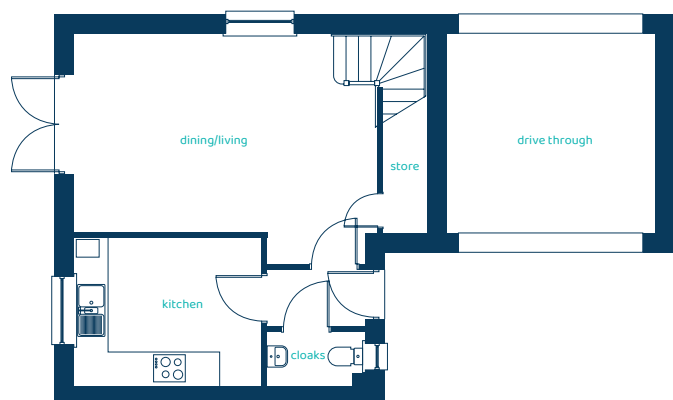

Room	Imperial	Metric
Dining/Living	17'1" x 14'6"	5.20m x 4.41m
Kitchen	10'1" x 10'0"	3.08m x 3.05m
Cloaks	2'10" x 6'4"	0.87m x 1.92m

First Floor Plan



Room	Imperial	Metric
Bedroom 1	12'4" x 12'5"	3.77m x 3.79m
Bedroom 2	8'10" x 12'1"	2.69m x 3.67m
Bedroom 3	7'9" x 11'10"	2.36m x 3.62m
Bathroom	6'10" x 8'6"	2.07m x 2.60m

The Marlow

3 bed mid mews

Anwyl Homes is a registered developer with the NHQB. The images on this literature are computer-generated. Specific plots may be 'handed' (mirrored), detached/semi-detached, elevation treatment/roof materials may vary, and any garages may be single or double. Room sizes are approximate, dimensions are taken from the longest room point and are for guidance only. Kitchen and bathroom layouts are indicative. These plans are correct at the time of creation but may be subject to change during construction. Please speak to your Homes Adviser for more details. The Marlow 29/08/25.

