

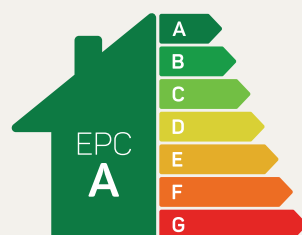

The Bretton

3 bed semi-detached/ mid mews/ end mews

Perfect for families and first-time buyers, this three-bedroom semi-detached home offers room to grow.



Predicted EPC rating

ANWYL

anwylhomes.co.uk

Ground Floor Plan

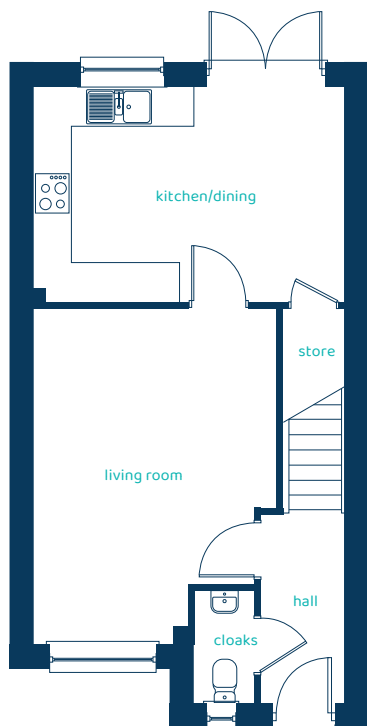

| Room | Imperial | Metric |
|----------------|---------------|---------------|
| Kitchen/Dining | 15'6" x 10'9" | 4.73m x 3.72m |
| Living Room | 12'2" x 16'9" | 3.71m x 5.10m |
| Cloaks | 2'11" x 5'7" | 0.90m x 1.70m |

First Floor Plan

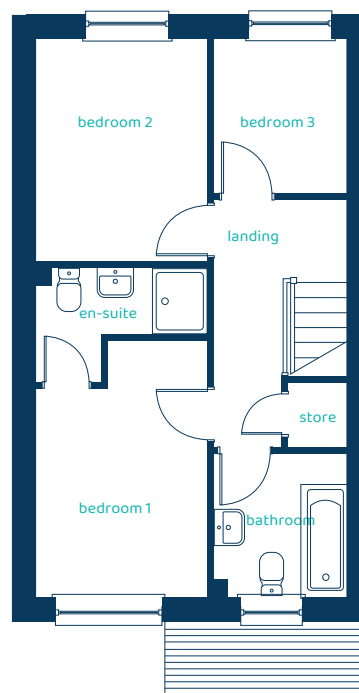

| Room | Imperial | Metric |
|-----------|--------------|---------------|
| Bedroom 1 | 8'6" x 12'9" | 2.59m x 3.88m |
| En-Suite | 8'6" x 5'9" | 2.59m x 1.74m |
| Bedroom 2 | 8'6" x 11'1" | 2.59m x 3.37m |
| Bedroom 3 | 6'9" x 7'8" | 2.05m x 2.35m |
| Bathroom | 6'9" x 7'2" | 2.05m x 2.18m |

The Bretton

3 bed semi-detached/ mid mews/ end mews

Anwyl Homes is a registered developer with the NHQB. The images on this literature are computer-generated. Specific plots may be 'handed' (mirrored), detached/semi-detached, elevation treatment/roof materials may vary, and any garages may be single or double. Room sizes are approximate, dimensions are taken from the longest room point and are for guidance only. Kitchen and bathroom layouts are indicative. These plans are correct at the time of creation but may be subject to change during construction. Please speak to your Homes Adviser for more details. The Bretton 14/10/25.

