



# The Sankey

2 bed semi-detached / end mews

Two bedrooms and a stunning design, the Sankey is a home with a real sense of contemporary style.

DISCOUNT TO OPEN MARKET

**ANWYL**

  
NEW  
HOMES  
QUALITY  
CODE

  
NEW HOMES  
OMBUDSMAN  
SERVICE

[anwylhomes.co.uk](https://anwylhomes.co.uk)

## Ground Floor Plan

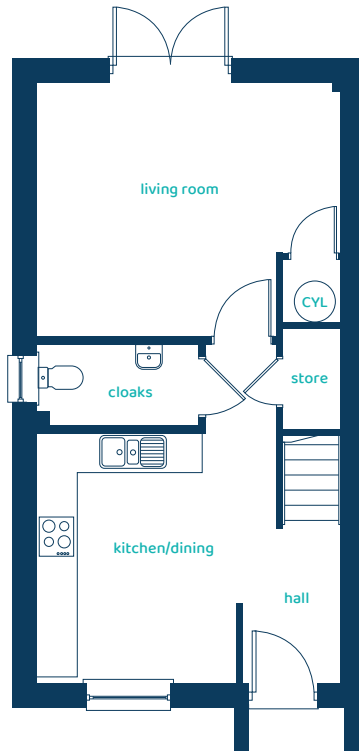

Room	Imperial	Metric
Living Room	14'10" x 12'4"	4.51m x 3.75m
Kitchen/Dining	11'8" x 12'2"	3.56m x 3.71m
Cloaks	7'10" x 3'11"	2.39m x 1.20m

## First Floor Plan

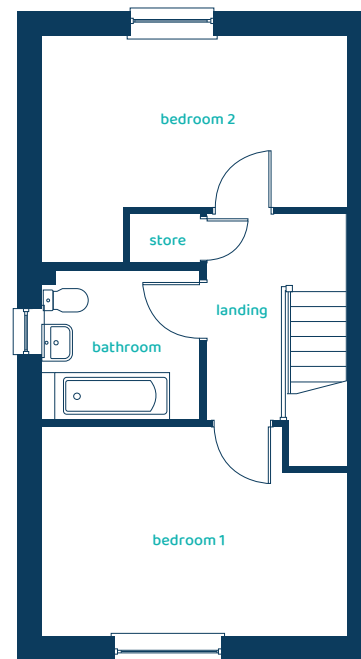

Room	Imperial	Metric
Bedroom 1	14'10" x 10'2"	4.51m x 3.09m
Bedroom 2	14'10" x 11'0"	4.51m x 3.35m
Bathroom	7'8" x 7'3"	2.33m x 2.21m

# The Sankey

## 2 bed semi-detached / end mews

Anwyl Homes is a registered developer with the NHQB. The images on this literature are computer-generated. Specific plots may be 'handed' (mirrored), detached/semi-detached, elevation treatment/roof materials may vary, and any garages may be single or double. Room sizes are approximate, dimensions are taken from the longest room point and are for guidance only. Kitchen and bathroom layouts are indicative. These plans are correct at the time of creation but may be subject to change during construction. Please speak to your Homes Adviser for more details. The Sankey 21/01/26.

Discount to open market homes are subject to eligibility, approval and terms.  
Please speak to your Homes Adviser for details.

DISCOUNT TO OPEN MARKET

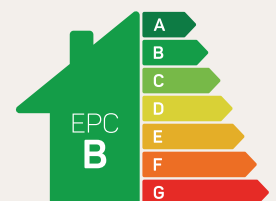

Predicted EPC rating



[anwylhomes.co.uk](http://anwylhomes.co.uk)