



# The Padgate

3 bed detached

A stylish detached home featuring modern, open-plan spaces and three beautiful bedrooms.

**ANWYL**



[anwylhomes.co.uk](http://anwylhomes.co.uk)

## Ground Floor Plan

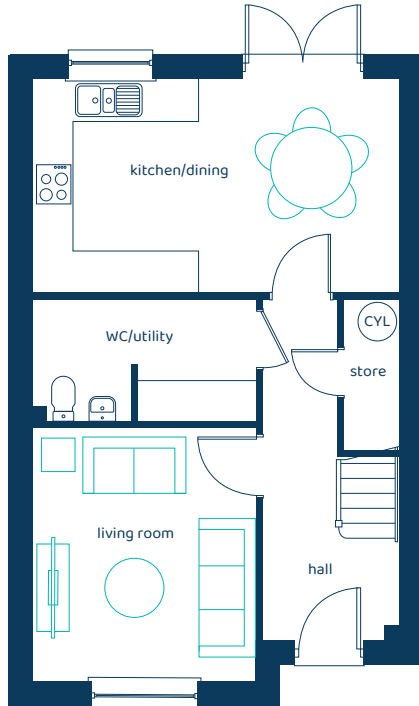

Room	Imperial	Metric
Living Room	10'10" x 12'3"	3.30m x 3.74m
Kitchen/Dining	17'10" x 10'3"	5.42m x 3.13m
WC/Utility	10'10" x 5'10"	3.30m x 1.78m

## First Floor Plan

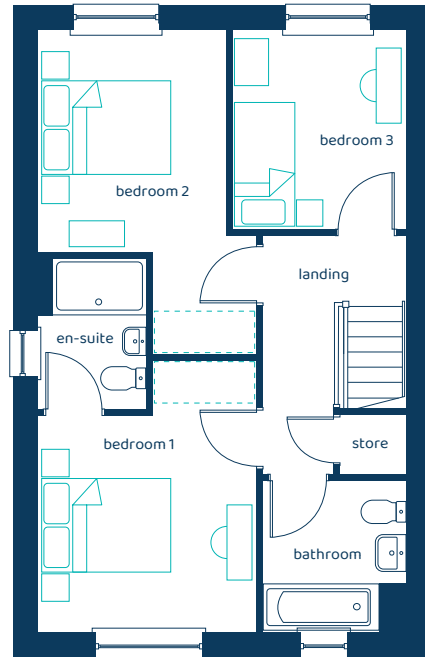

Room	Imperial	Metric
Bedroom 1	10'7" x 13'3"	3.22m x 4.03m
Bedroom 2	10'7" x 15'9"	3.22m x 4.79m
Bedroom 3	8'5" x 9'8"	2.56m x 2.93m
Bathroom	6'10" x 7'4"	2.09m x 2.23m
En-Suite	5'2" x 7'4"	1.58m x 2.23m

# The Padgate

## 3 bed detached

 Option for Built-in-Wardrobe.

Anwyl Homes is a registered developer with the NHQB. The images on this literature are computer-generated. Specific plots may be 'handed' (mirrored), detached/semi-detached, elevation treatment/roof materials may vary, and any garages may be single or double. Room sizes are approximate, dimensions are taken from the longest room point and are for guidance only. Kitchen and bathroom layouts are indicative. These plans are correct at the time of creation but may be subject to change during construction. Please speak to your Homes Adviser for more details. The Padgate 15/05/26.

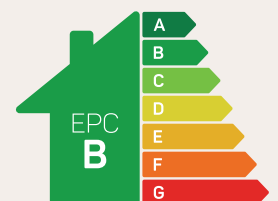

Predicted EPC rating