

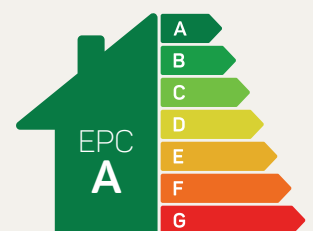

The Dodleston

3 bed detached

An elegant contemporary home with three beautiful bedrooms, two bathrooms and the added convenience of a downstairs cloaks.



Predicted EPC rating



anwylhomes.co.uk

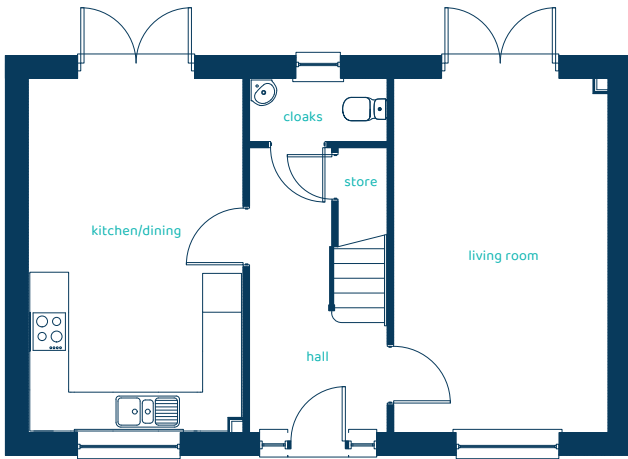

Ground Floor Plan

Room	Imperial	Metric
Kitchen / Dining	10'9" x 17'10"	3.27m x 5.42m
Living Room	10'9" x 17'10"	3.26m x 5.42m
Cloaks	6'10" x 3'1"	2.08m x 0.95m

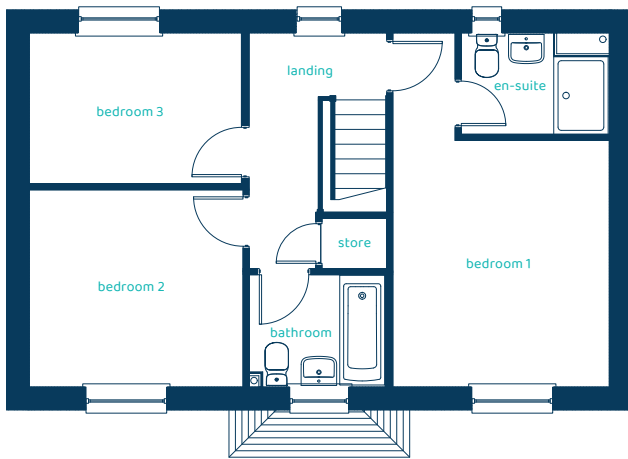

First Floor Plan

Room	Imperial	Metric
Bedroom 1	10'11" x 12'5"	3.32m x 3.79m
En-suite	7'5" x 5'1"	2.26m x 1.54m
Bedroom 2	10'9" x 9'11"	3.28m x 3.02m
Bedroom 3	10'8" x 7'7"	3.25m x 2.31m
Bathroom	6'11" x 5'7"	2.1m x 1.71m

The Dodleston

3 bed detached

Anwyl Homes is a registered developer with the NHQB. The images on this literature are computer-generated. Specific plots may be 'handed' (mirrored), detached/semi-detached, elevation treatment/roof materials may vary, and any garages may be single or double. Room sizes are approximate, dimensions are taken from the longest room point and are for guidance only. Kitchen and bathroom layouts are indicative. These plans are correct at the time of creation but may be subject to change during construction. Please speak to your Homes Adviser for more details. The Dodleston 30/03/26.

