

ANWYL
thoughtful homes



the glyn

4 bed detached with garage

A *spacious* 4 bedroom detached home. Key features include high ceilings, master en-suite, integral garage and an *open plan* kitchen diner.

www.anwylhomes.co.uk

got
questions?

call...

**03300
244 944**

everything considered.

ideal for
growing families

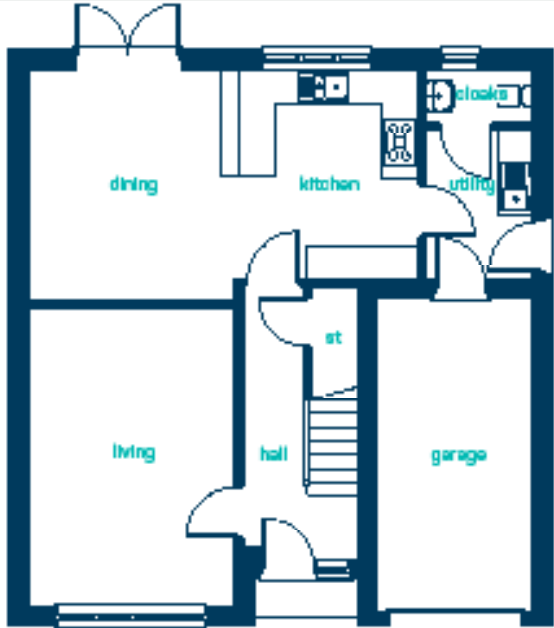

ground floor

living room	16' 10" x 11' 3"
kitchen/dining	21' 3" x 12' 7"
cloaks	6' 0" x 3' 3"
utility	8' 1" x 6' 0"

living room	5.13m x 3.44m
kitchen/dining	6.48m x 3.85m
cloaks	1.83m x 0.99m
utility	2.45m x 1.83m

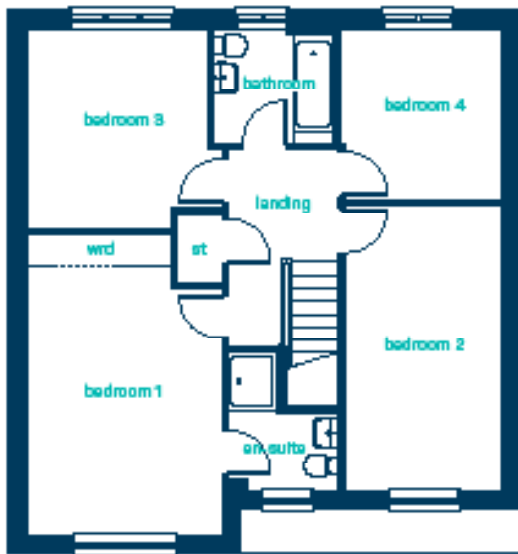

first floor

bedroom 1	17' 0" x 11' 3"
en-suite	7' 11" x 6' 7"
bedroom 2	16' 6" x 9' 1"
bedroom 3	12' 7" x 11' 3"
bedroom 4	9' 11" x 9' 7"
bathroom	7' 0" x 6' 8"

bedroom 1	5.19m x 3.44m
en-suite	2.43m x 2.01m
bedroom 2	5.03m x 2.77m
bedroom 3	3.84m x 3.44m
bedroom 4	3.03m x 2.91m
bathroom	2.13m x 2.03m

get in
touch...
**03300
244 944**

the glyn

4 bed detached with garage

www.anwylhomes.co.uk

This is a computer generated image of the glyn, elevation treatment may vary. Room sizes are approximate, dimensions are taken from the longest room point (please consult homes advisor for measurement points). Plots may be handed and any garages may be single or double. Kitchen and bathroom layouts are indicative. These plans are correct at the time of going to press, but may be subject to change during construction. Please ensure that you check for specific plot details.
27/10/2020 (glyn version)

everything considered.